

On the ORTHORA 200 the operation of the instruments like the micromotor, turbine and ultrasonic device are carried out with the instrument pedal built in the base of the chair.

There are two systems at your choice:

- 4-Function pedal DYN** → Dynamic speed / intensity per level
- 5-Function pedal** → Constant speed / intensity per level with connection of the spray function

The operating status is shown on the display mounted on the base.

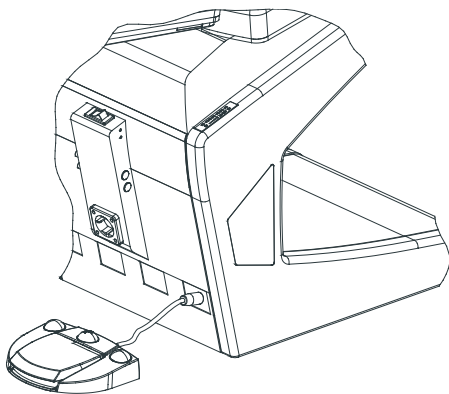

The instrument pedal is also available as free standing version.

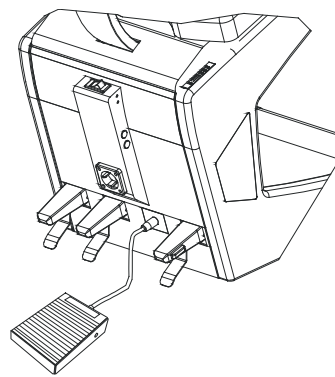

Optionally there is also the possibility to connect a free standing pedal for the operation of the drive function. The operation of the base functions like the selection of the levels, the spray function and the rotating direction of the micromotor are carried out with the instrument pedal which in parallel is built in the base of the chair.

### 4-Function pedal DYN

- ✓ Dynamic speed / intensity per level
- ✓ The spray function has to be preselected and is active when activating the drive function.

With the operation over the 4-function pedal DYN the output of the speed / intensity will be dynamic within the selectable levels. The speed / intensity of the individual levels is set in the programming mode (ST09).

With the 4-function pedal it is also possible to set constant values per level. (Speed / intensity constant within the levels).

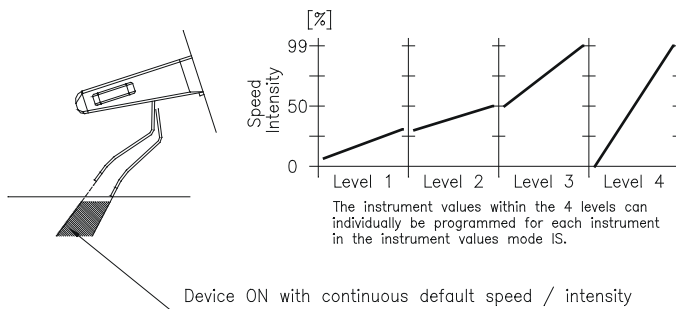

### 5-Function pedal

- ✓ Constant speed / intensity per level
- ✓ Spray function will be activated by pushing the drive function through.

With the operation over the 5-function pedal the output of the speed / intensity will be constant within the selectable levels. The speed / intensity of the individual levels is set in the electronic mode (ST01) or in the programming mode (ST09).

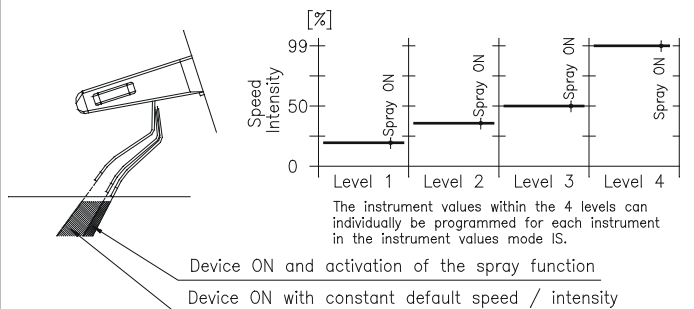

#### System requirements 4F

ORTHORA 200 with control ST09, serial nr. > OT1.02000 and micro controller > version 5.3 or by upgrading the ORTHORA 200 to control ST09.

#### System requirements 5F

ORTHORA 200 with control ST01 & ST09, serial nr. > OT1.00001 Standard equipment until the end of 2009

**4-Function pedal DYN**

Micromotor, turbine and ultrasonic devices are optionally controlled by the stand-alone 4-function pedal DYN and shown on the display A.

10 Speed level down or intensity down  
 11 Speed level up or intensity up  
 12 Device on (dynamic), selectable basic settings per level in mode IS  
 13 Spray on/off (1 x click)  
 LED on the display shines \*  
 Chip blower on/of (2 x click)  
 Water supply spray suppressed  
 LED on the display blinks \*  
 13 Micromotor changes direction of rotation when pressing button for more than 1.5 seconds.

S Display of special functions  
**Instrument display**  
 U Ultrasonic device  
 T Turbine  
 M Micromotor  
 Speed level \*  
 Spray on, LED shines  
 Chip blower, LED blinks

\* can be programmed as basic setting in the instrument characteristics IN.

**5-Function pedal**

Micromotor, turbine and ultrasonic devices are controlled by the stand-alone 5-function pedal and shown on the display A.

10 Speed level down or intensity down  
 11 Speed level up or intensity up  
 12 Device on  
 13 Spray on  
 14 Chip blower on/off  
 Water supply spray suppressed  
 LED on the display shines \*  
 14 Micromotor change direction of rotation when pressing button for more than 1.5 seconds

S Display of special functions  
**Instrument display**  
 U Ultrasonic device  
 T Turbine  
 M Micromotor  
 Speed level \*  
 Chip blower, blower air (LED shines)

\* can be programmed as basic setting in the instrument characteristics IN.

**Order number (standard)**

**Dynamic 4-function pedal DYN to OT200 built in unit → ST09**

- 320.6640.01 4-Function pedal DYN with display for operating instruments on „Unit“
- 320.6641.01 4-Function pedal DYN with display for operating instruments on "Rack" / "Cart"
- 320.6642.01 4-Function pedal DYN with display for operating instruments on "Unit&Rack" / "Cart"

**Order number (optional)**

**Dynamic 4-function pedal DYN free standing → ST09**

- 320.6640.25 4-Function pedal DYN, free standing with display for operating instruments on "Unit"
- 320.6641.25 4-Function pedal DYN, free standing with display for operating instruments on "Rack" / "Cart"
- 320.6642.25 4-Function pedal DYN, free standing with display for operating instruments on "Unit&Rack" / "Cart"

**Order number (optional)**

- 320.6637.01 1-Function pedal, free standing for parallel operation of the drive function with the system 4F

**Order number (optional)**

**5-Function pedal to OT200 built in unit → ST01 & ST09**

- 320.6555.01 5-Function pedal with display for operating instruments on „Unit“
- 320.6554.01 5-Function pedal with display for operating instruments on "Rack" / "Cart"
- 320.6553.01 5-Function pedal with display for operating instruments on "Unit&Rack" / "Cart"

**Order number (optional)**

**5-Functions pedal free standing → ST09**

- 320.6555.25 5-Function pedal DYN, free standing with display for operating instruments on "Unit"
- 320.6554.25 5-Function pedal DYN, free standing with display for operating instruments on "Rack" / "Cart"
- 320.6553.25 5-Function pedal DYN, free standing with display for operating instruments on "Unit&Rack" / "Cart"

**Order number (optional)**

- 320.6636.01 2-Function pedal, free standing for parallel operation of the drive function with the system 5F

**MIKRONA TECHNOLOGIE AG**

Wigartestrasse 8, CH-8957 Spreitenbach, Tel. +41 56 418 45 45, Fax +41 56 418 45 00, [swiss@mikrona.com](mailto:swiss@mikrona.com)

[www.mikrona.com](http://www.mikrona.com)

**MIKRONA**  
The Swiss Dental Technology